



FDR (FDD) :NSW (SYD) – FIBRE NETWORK
 PROJECT/SITE : THREDBO CBD GSM
 ADDRESS : FRIDAY DR THREDBO
 ORDER : E01866896

PROJECT NUMBER : --
 DUCT REFERENCE : TELD06592TP01

DRAWING INDEX

- CVR COVER SHEET
- R01 ROUTE OVERVIEW
- C01 CABLE ROUTE OVERVIEW
- 001-003 DETAILED ROUTE MAPS
- EWM ENVIRONMENTAL NOTES

BILL OF QUANTITIES

Type		
Proposed CABLE	Samsung 6/36 SMOF	380
Proposed CABLE	Samsung 12/96 SMOF	2115
Proposed CABLE	Samsung 12/72 SMOF (AJL)	60
Proposed PIT	MH - OTHER UTIL	6
Proposed PIT	A8 PIT - SIKA LOCKING LID	1
Proposed PIT	PIT - OTHER UTIL	11
Proposed PIT	A10 PIT - SIKA LOCKING LID	2
Proposed PIT	P4 PIT - CHANNEL (POLYCRETE LID)	5
Proposed PIT	P5 PIT - CHANNEL (POLYCRETE LID)	1
Proposed PIT	MH - BREAKOUT	3
Proposed PIT	Building Entry Point	1
Proposed SPLICE	FIST BC6 (AJL)	2
Proposed SPLICE	FIST BE6 (BJL)	2
Proposed TRENCH	P100/4xP32	11
Proposed TRENCH	P50	748
Proposed TRENCH	Leased Sub-Duct - New	1623

DISCLAIMER:

- FOOTAGE TEXT - ANY FOOTAGE DISTANCES SHOWN ARE INDICATIVE ONLY AND NEED TO BE CONFIRMED PRIOR TO CONSTRUCTION.
- PROPERTY BOUNDARIES - DETAILED ROUTE DRAWINGS SHOW PROPERTY BOUNDARIES ONLY. AS A RESULT THE ROAD WIDTH ALSO INCLUDES THE FOOTPATH AS THE BACK OF KERB LINES ARE NOT SHOWN (EG NO ROAD FORMATION IS SHOWN).

PRELIMINARY
DRAWING SET

CAD REF No: E01866896_PD.DWG

AS BUILT CHECKLIST

LIST OF THE STANDARD MINIMUM 'AS BUILT' INFORMATION REQUIRED AS PART OF COMPLETION OF ALL EXTERNAL FIBRE CABLE RUNS. NOTE THAT SOME OF THIS INFORMATION WILL ALREADY BE CONTAINED IN THE 'DESIGN/WORKING DRAWINGS' AND MAY ONLY NEED CONFIRMATION. ALL INFORMATION MUST BE ACCURATE AND LEGIBLE.

THE FOLLOWING MUST BE CHECKED AND TICKED OFF AT COMPLETION OF WORKS AS PART OF THE HANDOVER OF ALL AS BUILT DRAWINGS

- TICK
- WHOLE CABLE ROUTE FROM SPLICE TO CUSTOMER/SPLICE (TO INCLUDE NEW OPTUS DUCT, EXISTING OPTUS DUCT, DUCT LEASED FROM OTHER CARRIERS (EG TELSTRA) AND ANY AERIAL)
 - DISTANCES OR CHAINAGE BETWEEN PITS/MANHOLES (TO INCLUDE NEW OPTUS DUCT, EXISTING OPTUS DUCT, DUCT LEASED FROM OTHER CARRIERS (EG TELSTRA) AND ANY AERIAL)
 - PIT LOCATIONS AND PIT TYPES (EG: P5, A8, P9, A10 ETC). INCLUDE EXISTING OPTUS PITS AND ANY OTHER CARRIERS PITS/MANHOLES
 - ANY EXISTING AND/OR NEW SPLICES CREATED
 - CABLE READINGS FOR WHOLE ROUTE - FROM SPLICE TO CUSTOMER/SPLICE:
 MANUFACTURER: EG: SAMSUNG
 MODEL NUMBER: EG: 12/72 SMOF MINI
 SERIAL NUMBER: EG: BN12345
 DATE OF MANUFACTURE: EG: 09/2008
 CABLE DISTANCE IN METRES - SHOW ACTUAL CABLE METRE READINGS
 - ALL COILS AND THEIR LENGTHS (PIT OR AERIAL) - SHOW SHEATH READING AT COIL START AND END
 - OPTUS CONDUIT SIZE FOR BOTH NEW CONSTRUCTION AND EXISTING OPTUS (EG: P50 OR P100/3xP32, ETC)
 - DEPTH OF COVER AND OFFSET FROM PROPERTY LINE FOR NEW OPTUS CONSTRUCTION SHOW AT CHANGE OF DIRECTION OR EVERY 25 METRES
 - BORE LOG FOR NEW OPTUS CONSTRUCTION - SHOW BORE START/FINISH LOCATIONS
 - LEASED DUCT ALLOCATIONS (CONFIRM DUCT USED BY OPTUS) - FOR ALL LEASED DUCT (EG: TELSTRA, EA, CITIPOWER, ENERGEX, ETSA, ETC)
 - LEASED FACILITIES DUCT NUMBER (EG: TELD01274M01) (SHOULD BE ON DESIGN DRAWINGS ALREADY) - FOR ALL LEASED DUCT (EG: TELSTRA, EA, CITIPOWER, ENERGEX, ETSA, ETC)
 - MARKER POST LOCATIONS AND NUMBER: FROM PRE-ASSIGNED LIST, COMPLETE WITH GPS COORDINATES

AS BUILT APPROVAL:

CONTRACTOR COMPANY/REP: _____ / _____ DATE: _____
 OPTUS: _____ DATE: _____

OPTUS DISCLAIMER				
THIS DOCUMENT HAS BEEN PREPARED SOLELY FOR THE USE OF OPTUS NETWORKS PTY. LTD. (ACN 008 570 330) FOR USE IN MAINTAINING OPTUS FACILITIES. IT HAS NOT BEEN CREATED FOR ANY OTHER USE. IT SHOULD NOT BE SCALED TO LOCATE OPTUS ASSET. NO WARRANTY IS GIVEN THAT THE INFORMATION IS ACCURATE OR COMPLETE. IF YOU REQUIRE FURTHER INFORMATION REGARDING THE LOCATION OF AN OPTUS ASSET PLEASE PHONE 1800 505 777.				
PD	20.01.16	PRELIMINARY DRAWING ISSUE	SNC	JV
REV	DATE	DESCRIPTION	DRAWN	APPROVED
AMENDMENTS				

SYMBOL LEGEND	
	CONDUIT - PROPOSED OPTUS CONSTRUCTION
	CONDUIT - EXISTING
	AERIAL STRAND (CATENARY WIRE)
	DIRECT BURIED CABLE
	CONDUIT CONFIGURATION PHOTO REFERENCE NUMBER REFER PHOTO PACK DOCUMENTATION

	OPTUS 5 PIT		ENVIRONMENTAL NOTES REFER EWM SHEETS
	OPTUS 8 PIT		FIBRE TERMINATION POINT
	OPTUS 9 PIT		POWER POLE
	OPTUS 10 PIT		OPTUS MARKER POST
	OTHER UTILITY PIT		FIBRE CABLE COIL FIBRE CABLE COIL LENGTH
	OTHER UTILITY MANHOLE		DEPTH OF COVER (m)
	OTHER UTILITY MANHOLE BREAKOUT REQUIRED		CONDUIT OFFSET FROM PROPERTY LINE (m)

OPTUS *yes*

CONTRACTOR

CIS international
Communications Infrastructure Services

KEY PLAN

YES OPTUS - FIBRE OPTIC CABLE PROJECTS		
DRAWING TITLE: NSW (SYD) - FIBRE NETWORK THREDBO CBD GSM FRIDAY DR THREDBO FIBRE CABLE ROUTE		
DUCT REFERENCE: TELD06592TP01		
PROJECT/EO No: --/E01866896		
CADREF No: E01866896_PD.DWG		
SCALE 1:2000	SHEET No. CVR	REV PD

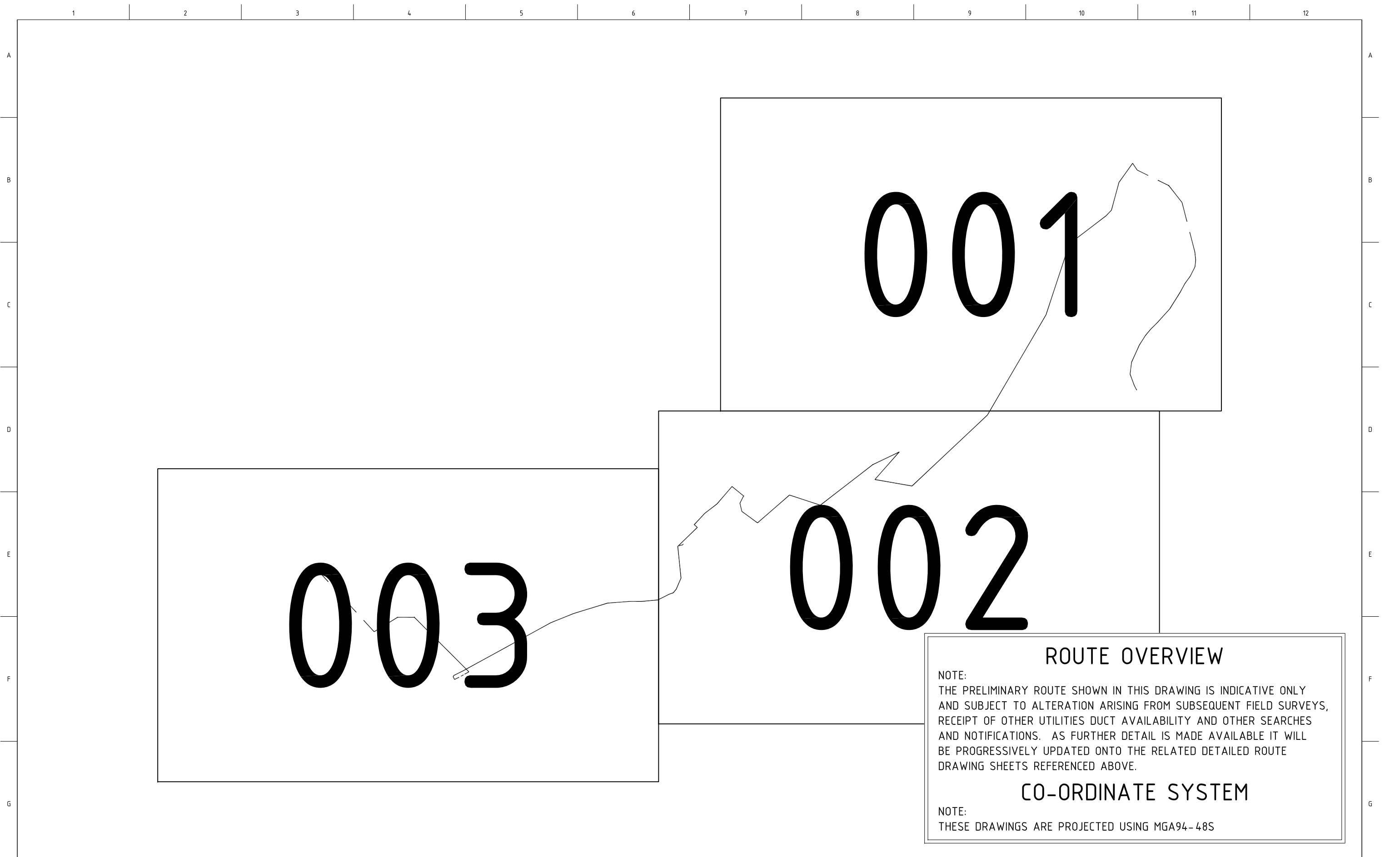

ROUTE OVERVIEW

NOTE:
 THE PRELIMINARY ROUTE SHOWN IN THIS DRAWING IS INDICATIVE ONLY AND SUBJECT TO ALTERATION ARISING FROM SUBSEQUENT FIELD SURVEYS, RECEIPT OF OTHER UTILITIES DUCT AVAILABILITY AND OTHER SEARCHES AND NOTIFICATIONS. AS FURTHER DETAIL IS MADE AVAILABLE IT WILL BE PROGRESSIVELY UPDATED ONTO THE RELATED DETAILED ROUTE DRAWING SHEETS REFERENCED ABOVE.

CO-ORDINATE SYSTEM

NOTE:
 THESE DRAWINGS ARE PROJECTED USING MGA94-48S

OPTUS DISCLAIMER
 THIS DOCUMENT HAS BEEN PREPARED SOLELY FOR THE USE OF OPTUS NETWORKS PTY. LTD. (ACN 008 570 330) FOR USE IN MAINTAINING OPTUS FACILITIES. IT HAS NOT BEEN CREATED FOR ANY OTHER USE. IT SHOULD NOT BE SCALED TO LOCATE OPTUS ASSET. NO WARRANTY IS GIVEN THAT THE INFORMATION IS ACCURATE OR COMPLETE. IF YOU REQUIRE FURTHER INFORMATION REGARDING THE LOCATION OF AN OPTUS ASSET PLEASE PHONE 1800 505 777.

LOCATION OF UTILITIES ARE INDICATIVE ONLY. ACTUAL LOCATIONS MUST BE DETERMINED ON SITE BY THE UTILITY OWNER FOR THE CONTRACTOR.

REV	DATE	DESCRIPTION	DRAWN	APPROVED
PD	20.01.16	PRELIMINARY DRAWING ISSUE	SNC	JV
AMENDMENTS				

SYMBOL LEGEND	
	CONDUIT - PROPOSED OPTUS CONSTRUCTION
	CONDUIT - EXISTING
	AERIAL STRAND (CATENARY WIRE)
	DIRECT BURIED CABLE
	CONDUIT CONFIGURATION
	PHOTO REFERENCE NUMBER REFER PHOTO PACK DOCUMENTATION
	OPTUS 5 PIT
	OPTUS 8 PIT
	OPTUS 9 PIT
	OPTUS 10 PIT
	OTHER UTILITY PIT
	OTHER UTILITY MANHOLE
	OTHER UTILITY MANHOLE BREAKOUT REQUIRED
	ENVIRONMENTAL NOTES REFER EWM SHEETS
	FIBRE TERMINATION POINT
	POWER POLE
	OPTUS MARKER POST
	FIBRE CABLE COIL
	FIBRE CABLE COIL LENGTH
	DEPTH OF COVER (m)
	CONDUIT OFFSET FROM PROPERTY LINE (m)

OPTUS *yes*

CONTRACTOR

CIS international
 Communications Infrastructure Services

N KEY PLAN

YES OPTUS - FIBRE OPTIC CABLE PROJECTS		
DRAWING TITLE: NSW (SYD) - FIBRE NETWORK THREDBO CBD GSM FRIDAY DR THREDBO FIBRE CABLE ROUTE		
DUCT REFERENCE: TELD06592TP01		
PROJECT/EO No: --/E01866896		
CADREF No: E01866896_PD.DWG		
SCALE 1:2000	SHEET No: R01	REV PD

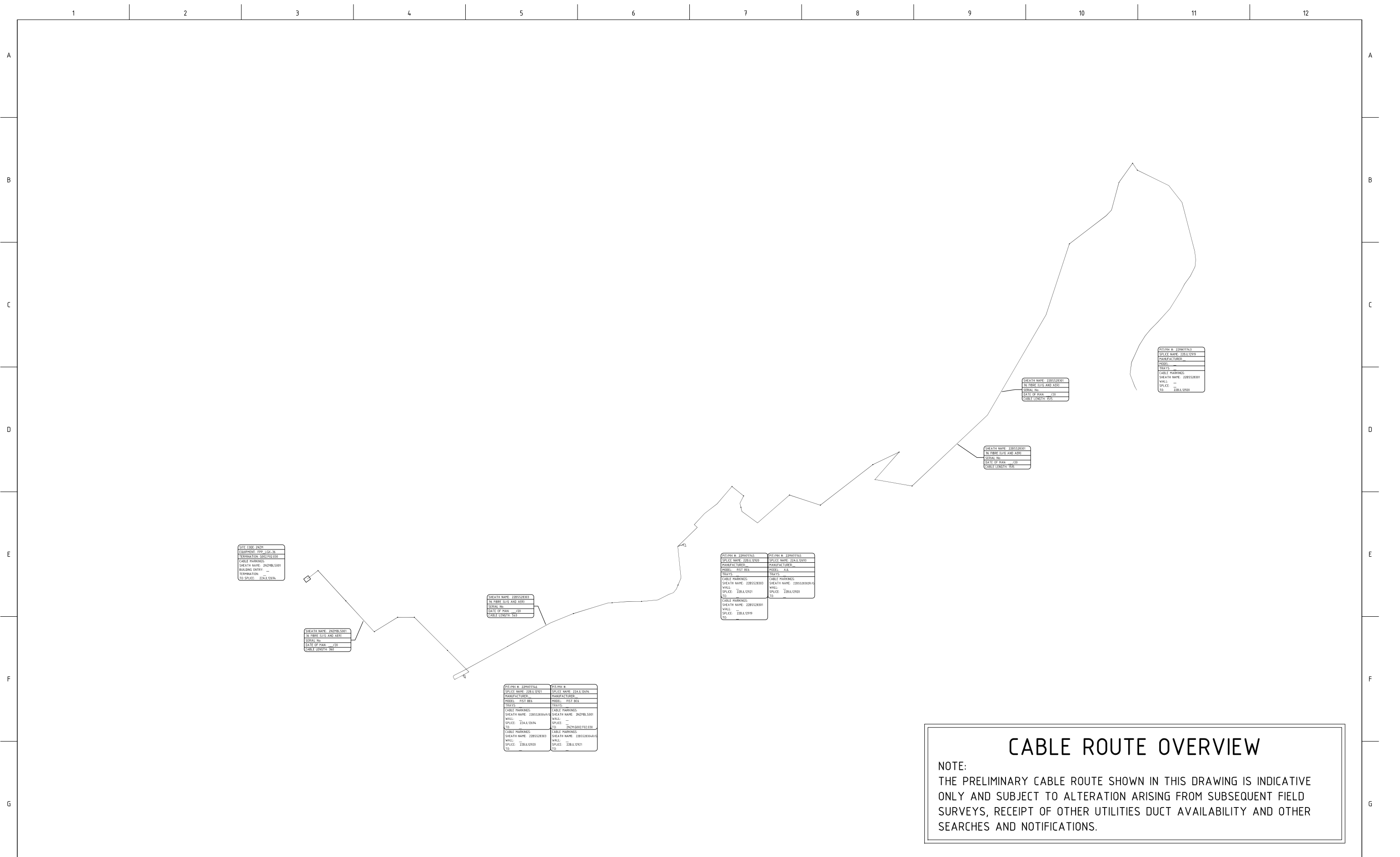

OTE CODE: 220M
EQUIPMENT: 2PP - GIG-16
TERMINATION: 5055742330
CABLE MARKING:
SHEATH NAME: 2ND78L5001
BUILDING ENTRY: --
TERMINATION: --
CO. SPICE: 22A.12564

SHEATH NAME: 2ND78L5001
IN FIBRE DUCT AND AERI
SERIAL No: --
DATE OF MAN: /20
CABLE LENGTH: 90

SHEATH NAME: 22B528301
IN FIBRE DUCT AND AERI
SERIAL No: --
DATE OF MAN: /20
CABLE LENGTH: 95

OT/PMI #: 22947745
SPLICE NAME: 22B.12922
DIAMETER: F01 864
TRAITS: --
CABLE MARKING: SHEATH NAME: 22B528303
WALL: 22B.A.12921
CO: --
CABLE MARKING: SHEATH NAME: 22B528301
WALL: 22B.A.12919
CO: --

OT/PMI #: 22947745
SPLICE NAME: 22A.A.12915
DIAMETER: F01 864
TRAITS: --
CABLE MARKING: SHEATH NAME: 22B528303
WALL: 22B.A.12920
CO: --

SHEATH NAME: 22B528301
IN FIBRE DUCT AND AERI
SERIAL No: --
DATE OF MAN: /20
CABLE LENGTH: 95

SHEATH NAME: 22B528301
IN FIBRE DUCT AND AERI
SERIAL No: --
DATE OF MAN: /20
CABLE LENGTH: 95

OT/PMI #: 22947745
SPLICE NAME: 22B.A.12920
DIAMETER: F01 864
TRAITS: --
CABLE MARKING: SHEATH NAME: 22B528301
WALL: --
CO: 22B.A.12920

OT/PMI #: 22947745
SPLICE NAME: 22B.12921
DIAMETER: F01 864
TRAITS: --
CABLE MARKING: SHEATH NAME: 22B528304
WALL: 22A.A.12914
CO: 22B.A.12921
CABLE MARKING: SHEATH NAME: 22B528303
WALL: 22B.A.12920
CO: --

CABLE ROUTE OVERVIEW

NOTE:
THE PRELIMINARY CABLE ROUTE SHOWN IN THIS DRAWING IS INDICATIVE ONLY AND SUBJECT TO ALTERATION ARISING FROM SUBSEQUENT FIELD SURVEYS, RECEIPT OF OTHER UTILITIES DUCT AVAILABILITY AND OTHER SEARCHES AND NOTIFICATIONS.

OPTUS DISCLAIMER
THIS DOCUMENT HAS BEEN PREPARED SOLELY FOR THE USE OF OPTUS NETWORKS PTY. LTD. (ACN 008 570 330) FOR USE IN MAINTAINING OPTUS FACILITIES. IT HAS NOT BEEN CREATED FOR ANY OTHER USE. IT SHOULD NOT BE SCALED TO LOCATE OPTUS ASSET. NO WARRANTY IS GIVEN THAT THE INFORMATION IS ACCURATE OR COMPLETE. IF YOU REQUIRE FURTHER INFORMATION REGARDING THE LOCATION OF AN OPTUS ASSET PLEASE PHONE 1800 505 777.

LOCATION OF UTILITIES ARE INDICATIVE ONLY. ACTUAL LOCATIONS MUST BE DETERMINED ON SITE BY THE UTILITY OWNER FOR THE CONTRACTOR.

REV	DATE	DESCRIPTION	DRAWN	APPROVED
PD	20.01.16	PRELIMINARY DRAWING ISSUE	SNC	JV
AMENDMENTS				

SYMBOL LEGEND

- CONDUIT - PROPOSED OPTUS CONSTRUCTION
- CONDUIT - EXISTING
- A— AERIAL STRAND (CATENARY WIRE)
- DB DIRECT BURIED CABLE
- P50 CONDUIT CONFIGURATION
- PHOTO REFERENCE NUMBER REFER PHOTO PACK DOCUMENTATION

5	OPTUS 5 PIT	EM23	ENVIRONMENTAL NOTES REFER EWM SHEETS
8	OPTUS 8 PIT	○	FIBRE TERMINATION POINT
9	OPTUS 9 PIT	●	POWER POLE
10	OPTUS 10 PIT	▲	OPTUS MARKER POST
OTHER UTILITY PIT	◻	72F	FIBRE CABLE COIL
OTHER UTILITY MANHOLE	◻	4.0m	FIBRE CABLE COIL LENGTH
OTHER UTILITY MANHOLE BREAKOUT REQUIRED	◻	0.6	DEPTH OF COVER (m)
		2.4	CONDUIT OFFSET FROM PROPERTY LINE (m)

OPTUS *yes*

CONTRACTOR

CIS international
Communications Infrastructure Services

N KEY PLAN

YES OPTUS - FIBRE OPTIC CABLE PROJECTS		
DRAWING TITLE: NSW (SYD) - FIBRE NETWORK THREDBO CBD GSM FRIDAY DR THREDBO FIBRE CABLE ROUTE		
DUCT REFERENCE: TELD06592TP01		
PROJECT/EO No: --/E01866896		
CADREF No: E01866896_PD.DWG		
SCALE 1:2000	SHEET No: C01	REV PD

NOTES:

1. 1 x P50 CONDUIT (NO SUBDUCTS) USED UNLESS OTHERWISE NOTED (UNDERGROUND).
2. BOUNDARY TO BE LOCATED PRIOR TO CONSTRUCTION.
3. CONDUIT DEPTH TO BE IN ACCORDANCE WITH OPTUS SPECIFICATIONS. ANY VARIATION IS TO BE NOTIFIED TO OPTUS PRIOR TO COMMENCEMENT OF CONSTRUCTION.
4. SERVICES SHOWN ARE INDICATIVE ONLY. IT IS THE CONTRACTORS RESPONSIBILITY TO LOCATE ALL UTILITIES ACCURATELY PRIOR TO CONSTRUCTION.
5. ALL RELEVANT PUBLIC AUTHORITIES ARE TO BE NOTIFIED PRIOR TO COMMENCEMENT OF ANY WORK.
6. ALL AFFECTED PROPERTIES TO HAVE ACCESS MAINTAINED AT ALL TIMES.
7. WHERE TRENCHING OCCURS, COMPLY WITH GUIDELINES FOR TRENCHING IN URBAN AREAS.
8. BEFORE THE COMMENCEMENT OF ANY TRIMMING OF TREES, THE RELEVANT LOCAL COUNCIL IS TO BE NOTIFIED FOR APPROVAL AND/OR SUPERVISION PRIOR TO CONSTRUCTION.
9. REFER TO ATTACHED SHEETS FOR SYMBOL LEGENDS AND ENVIRONMENTAL WORK METHOD DEFINITIONS.
10. THE CONDUIT, SUBDUCT AND COVER INFORMATION HAS BEEN SUPPLIED BY THE CONTRACTOR AND/OR OPTUS.
11. CONDUIT COVER LOCATIONS ARE INDICATIVE ONLY AND ARE TO BE USED AS A GUIDE. CARE SHOULD BE TAKEN WHEN WORKING IN PROXIMITY OF CONDUIT.
12. REFER TO ROUTE OVERVIEW SHEET FOR LOCALITY.
13. PITS AND POLES HAVE BEEN APPROXIMATELY LOCATED. THE UNDERGROUND CONDUIT HAS NOT BEEN LOCATED AND THE POSITION SHOWN IS INDICATIVE ONLY.
14. CADASTRE COPYRIGHT OPTUS AND LAND & PROPERTY INFORMATION.

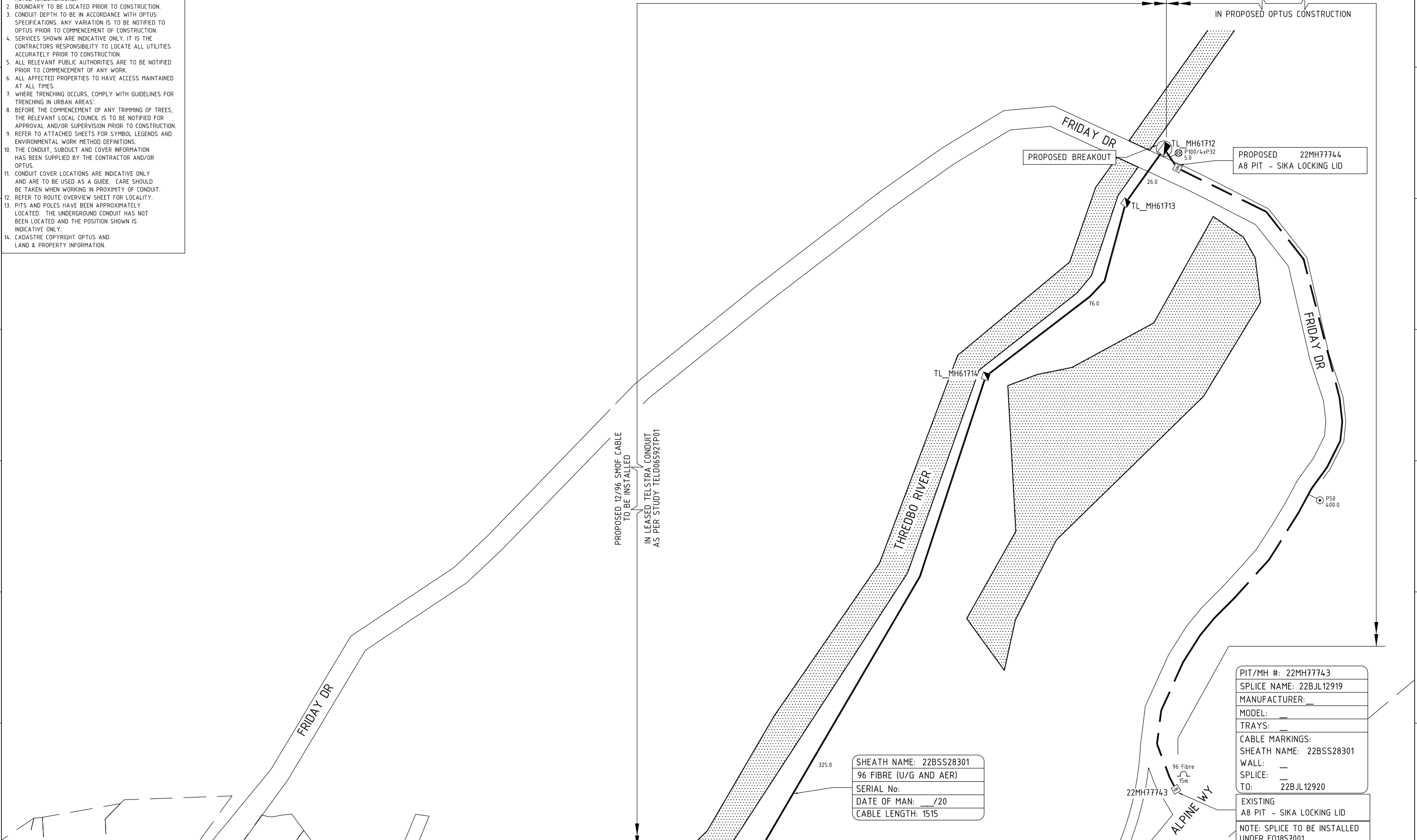

SHEATH NAME: 22BSS28301
 96 FIBRE (U/G AND AER)
 SERIAL No:
 DATE OF MAN: ___/___/20
 CABLE LENGTH: 1515

PIT/MH #: 22MH77743
 SPLICE NAME: 22BJL12919
 MANUFACTURER: ___
 MODEL: ___
 TRAYS: ___
 CABLE MARKINGS:
 SHEATH NAME: 22BSS28301
 WALL: ___
 SPLICE: ___
 TO: 22BJL12920

EXISTING
 A8 PIT - SIKA LOCKING LID
 NOTE: SPLICE TO BE INSTALLED UNDER E01857001

OPTUS DISCLAIMER
 THIS DOCUMENT HAS BEEN PREPARED SOLELY FOR THE USE OF OPTUS NETWORKS PTY. LTD. (ACN 008 570 330) FOR USE IN MAINTAINING OPTUS FACILITIES. IT HAS NOT BEEN CREATED FOR ANY OTHER USE. IT SHOULD NOT BE SCALED TO LOCATE OPTUS ASSET. NO WARRANTY IS GIVEN THAT THE INFORMATION IS ACCURATE OR COMPLETE. IF YOU REQUIRE FURTHER INFORMATION REGARDING THE LOCATION OF AN OPTUS ASSET PLEASE PHONE 1800 505 777.

LOCATION OF UTILITIES ARE INDICATIVE ONLY. ACTUAL LOCATIONS MUST BE DETERMINED ON SITE BY THE UTILITY OWNER FOR THE CONTRACTOR.

REV	DATE	DESCRIPTION	DRAWN	APPROVED
PD	20.01.16	PRELIMINARY DRAWING ISSUE	SNC	JV
AMENDMENTS				

SYMBOL LEGEND

- CONDUIT - PROPOSED OPTUS CONSTRUCTION
- CONDUIT - EXISTING
- A- AERIAL STRAND (CATENARY WIRE)
- DB DIRECT BURIED CABLE
- P50 CONDUIT CONFIGURATION
- 1 PHOTO REFERENCE NUMBER REFER PHOTO PACK DOCUMENTATION

5	OPTUS 5 PIT	EM23	ENVIRONMENTAL NOTES REFER EWM SHEETS
8	OPTUS 8 PIT	○	FIBRE TERMINATION POINT
9	OPTUS 9 PIT	○	POWER POLE
10	OPTUS 10 PIT	▲	OPTUS MARKER POST
□	OTHER UTILITY PIT	72F	FIBRE CABLE COIL
□	OTHER UTILITY MANHOLE	4.0m	FIBRE CABLE COIL LENGTH
□	OTHER UTILITY MANHOLE BREAKOUT REQUIRED	0.6	DEPTH OF COVER (m)
		2.4	CONDUIT OFFSET FROM PROPERTY LINE (m)

OPTUS *yes*

CONTRACTOR

CIS international
 Communications Infrastructure Services

KEY PLAN

001

002

003

YES OPTUS - FIBRE OPTIC CABLE PROJECTS

DRAWING TITLE:
 NSW (SYD) - FIBRE NETWORK
 THREDBO CBD GSM
 FRIDAY DR THREDBO
 FIBRE CABLE ROUTE

DUCT REFERENCE: TELD06592TP01
 PROJECT/EO No: --/E01866896
 CADREF No: E01866896_PD.DWG

SCALE: 1:2000 SHEET No: 001 REV: PD

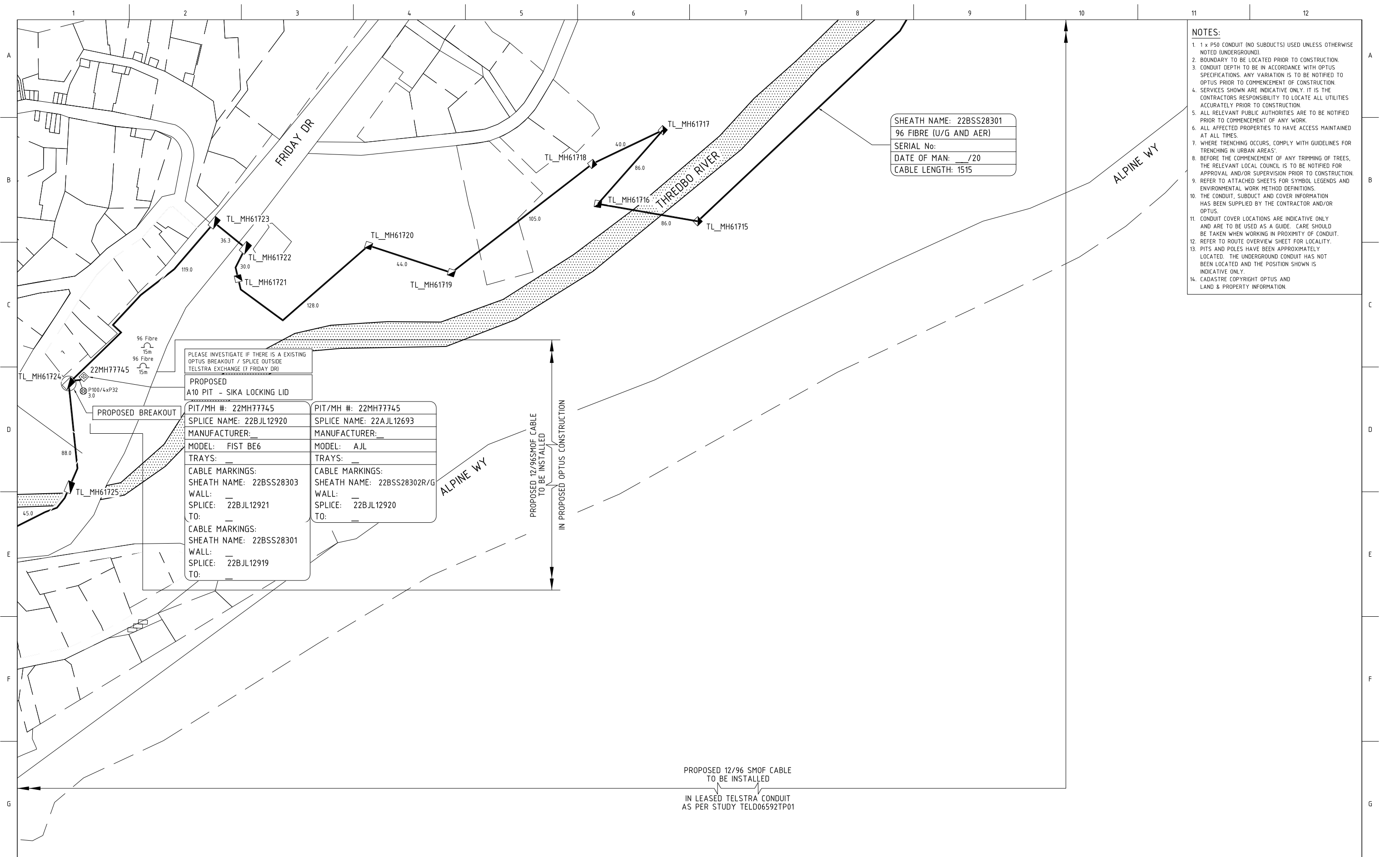

- NOTES:**
- 1 x P50 CONDUIT (NO SUBJECTS) USED UNLESS OTHERWISE NOTED (UNDERGROUND).
 - BOUNDARY TO BE LOCATED PRIOR TO CONSTRUCTION.
 - CONDUIT DEPTH TO BE IN ACCORDANCE WITH OPTUS SPECIFICATIONS. ANY VARIATION IS TO BE NOTIFIED TO OPTUS PRIOR TO COMMENCEMENT OF CONSTRUCTION.
 - SERVICES SHOWN ARE INDICATIVE ONLY. IT IS THE CONTRACTOR'S RESPONSIBILITY TO LOCATE ALL UTILITIES ACCURATELY PRIOR TO CONSTRUCTION.
 - ALL RELEVANT PUBLIC AUTHORITIES ARE TO BE NOTIFIED PRIOR TO COMMENCEMENT OF ANY WORK.
 - ALL AFFECTED PROPERTIES TO HAVE ACCESS MAINTAINED AT ALL TIMES.
 - WHERE TRENCHING OCCURS, COMPLY WITH GUIDELINES FOR TRENCHING IN URBAN AREAS.
 - BEFORE THE COMMENCEMENT OF ANY TRIMMING OF TREES, THE RELEVANT LOCAL COUNCIL IS TO BE NOTIFIED FOR APPROVAL AND/OR SUPERVISION PRIOR TO CONSTRUCTION.
 - REFER TO ATTACHED SHEETS FOR SYMBOL LEGENDS AND ENVIRONMENTAL WORK METHOD DEFINITIONS.
 - THE CONDUIT, SUBDUIT AND COVER INFORMATION HAS BEEN SUPPLIED BY THE CONTRACTOR AND/OR OPTUS.
 - CONDUIT COVER LOCATIONS ARE INDICATIVE ONLY AND ARE TO BE USED AS A GUIDE. CARE SHOULD BE TAKEN WHEN WORKING IN PROXIMITY OF CONDUIT.
 - REFER TO ROUTE OVERVIEW SHEET FOR LOCALITY.
 - PITS AND POLES HAVE BEEN APPROXIMATELY LOCATED. THE UNDERGROUND CONDUIT HAS NOT BEEN LOCATED AND THE POSITION SHOWN IS INDICATIVE ONLY.
 - CADASTRE COPYRIGHT OPTUS AND LAND & PROPERTY INFORMATION.

OPTUS DISCLAIMER
 THIS DOCUMENT HAS BEEN PREPARED SOLELY FOR THE USE OF OPTUS NETWORKS PTY. LTD. (ACN 008 570 330) FOR USE IN MAINTAINING OPTUS FACILITIES. IT HAS NOT BEEN CREATED FOR ANY OTHER USE. IT SHOULD NOT BE SCALED TO LOCATE OPTUS ASSET. NO WARRANTY IS GIVEN THAT THE INFORMATION IS ACCURATE OR COMPLETE. IF YOU REQUIRE FURTHER INFORMATION REGARDING THE LOCATION OF AN OPTUS ASSET PLEASE PHONE 1800 505 777.

LOCATION OF UTILITIES ARE INDICATIVE ONLY. ACTUAL LOCATIONS MUST BE DETERMINED ON SITE BY THE UTILITY OWNER FOR THE CONTRACTOR.

REV	DATE	DESCRIPTION	DRAWN	APPROVED
PD	20.01.16	PRELIMINARY DRAWING ISSUE	SNC	JV
AMENDMENTS				

- SYMBOL LEGEND**
- CONDUIT - PROPOSED OPTUS CONSTRUCTION
 - CONDUIT - EXISTING
 - A- AERIAL STRAND (CATENARY WIRE)
 - DB DIRECT BURIED CABLE
 - P50 CONDUIT CONFIGURATION
 - PHOTO REFERENCE NUMBER REFER PHOTO PACK DOCUMENTATION

- 5 OPTUS 5 PIT
- 8 OPTUS 8 PIT
- 9 OPTUS 9 PIT
- 10 OPTUS 10 PIT
- OTHER UTILITY PIT
- OTHER UTILITY MANHOLE
- OTHER UTILITY MANHOLE BREAKOUT REQUIRED
- ENVIRONMENTAL NOTES REFER EWM SHEETS
- FIBRE TERMINATION POINT
- POWER POLE
- OPTUS MARKER POST
- FIBRE CABLE COIL
- FIBRE CABLE COIL LENGTH
- DEPTH OF COVER (m)
- CONDUIT OFFSET FROM PROPERTY LINE (m)



KEY PLAN

001

002

003

YES OPTUS - FIBRE OPTIC CABLE PROJECTS		
DRAWING TITLE: NSW (SYD) - FIBRE NETWORK THREDBO CBD GSM FRIDAY DR THREDBO FIBRE CABLE ROUTE		
DUCT REFERENCE: TELD06592TP01		
PROJECT/EO No: --/E01866896		
CADREF No: E01866896_PD.DWG		
SCALE 1:2000	SHEET No: 002	REV PD

- NOTES:**
- 1 x P50 CONDUIT (NO SUBJECTS) USED UNLESS OTHERWISE NOTED (UNDERGROUND).
 - BOUNDARY TO BE LOCATED PRIOR TO CONSTRUCTION.
 - CONDUIT DEPTH TO BE IN ACCORDANCE WITH OPTUS SPECIFICATIONS. ANY VARIATION IS TO BE NOTIFIED TO OPTUS PRIOR TO COMMENCEMENT OF CONSTRUCTION.
 - SERVICES SHOWN ARE INDICATIVE ONLY. IT IS THE CONTRACTOR'S RESPONSIBILITY TO LOCATE ALL UTILITIES ACCURATELY PRIOR TO CONSTRUCTION.
 - ALL RELEVANT PUBLIC AUTHORITIES ARE TO BE NOTIFIED PRIOR TO COMMENCEMENT OF ANY WORK.
 - ALL AFFECTED PROPERTIES TO HAVE ACCESS MAINTAINED AT ALL TIMES.
 - WHERE TRENCHING OCCURS, COMPLY WITH GUIDELINES FOR TRENCHING IN URBAN AREAS.
 - BEFORE THE COMMENCEMENT OF ANY TRIMMING OF TREES, THE RELEVANT LOCAL COUNCIL IS TO BE NOTIFIED FOR APPROVAL AND/OR SUPERVISION PRIOR TO CONSTRUCTION.
 - REFER TO ATTACHED SHEETS FOR SYMBOL LEGENDS AND ENVIRONMENTAL WORK METHOD DEFINITIONS.
 - THE CONDUIT, SUBDUCT AND COVER INFORMATION HAS BEEN SUPPLIED BY THE CONTRACTOR AND/OR OPTUS.
 - CONDUIT COVER LOCATIONS ARE INDICATIVE ONLY AND ARE TO BE USED AS A GUIDE. CARE SHOULD BE TAKEN WHEN WORKING IN PROXIMITY OF CONDUIT.
 - REFER TO ROUTE OVERVIEW SHEET FOR LOCALITY.
 - PITS AND POLES HAVE BEEN APPROXIMATELY LOCATED. THE UNDERGROUND CONDUIT HAS NOT BEEN LOCATED AND THE POSITION SHOWN IS INDICATIVE ONLY.
 - CADASTRE COPYRIGHT OPTUS AND LAND & PROPERTY INFORMATION.

SITE CODE: 2NZM
 EQUIPMENT: FPP_LGX-36
 TERMINATION: G002.F02.030
 CABLE MARKINGS:
 SHEATH NAME: 2NZMBLS001
 BUILDING ENTRY: _
 TERMINATION: _
 TO SPLICE: 22AJL12694

PROPOSED
 P4 PIT - CHANNEL POLYCRETE LID

SHEATH NAME: 2NZMBLS001
 36 FIBRE (U/G AND AER)
 SERIAL No:
 DATE OF MAN: _/20
 CABLE LENGTH: 360

SHEATH NAME: 22BSS28303
 96 FIBRE (U/G AND AER)
 SERIAL No:
 DATE OF MAN: _/20
 CABLE LENGTH: 540

PROPOSED
 A10 PIT - SIKA LOCKING LID

PIT/MH #: 22MH77746	PIT/MH #:
SPLICE NAME: 22BJL12921	SPLICE NAME: 22AJL12694
MANUFACTURER:	MANUFACTURER:
MODEL: FIST BE6	MODEL: FIST BC6
TRAYS:	TRAYS:
CABLE MARKINGS:	CABLE MARKINGS:
SHEATH NAME: 22BSS28304R/G	SHEATH NAME: 2NZMBLS001
WALL:	WALL:
SPLICE: 22AJL12694	SPLICE: _
TO:	TO: 2NZM.G002.F02.030
CABLE MARKINGS:	CABLE MARKINGS:
SHEATH NAME: 22BSS28303	SHEATH NAME: 22BSS28304R/G
WALL:	WALL:
SPLICE: 22BJL12920	SPLICE: 22BJL12921
TO:	TO:

PROPOSED 6/36 SMOF CABLE TO BE INSTALLED
 IN PROPOSED OPTUS CONSTRUCTION

PROPOSED 12/96 SMOF CABLE TO BE INSTALLED
 IN LEASED TELSTRA CONDUIT AS PER STUDY TELD06592P01

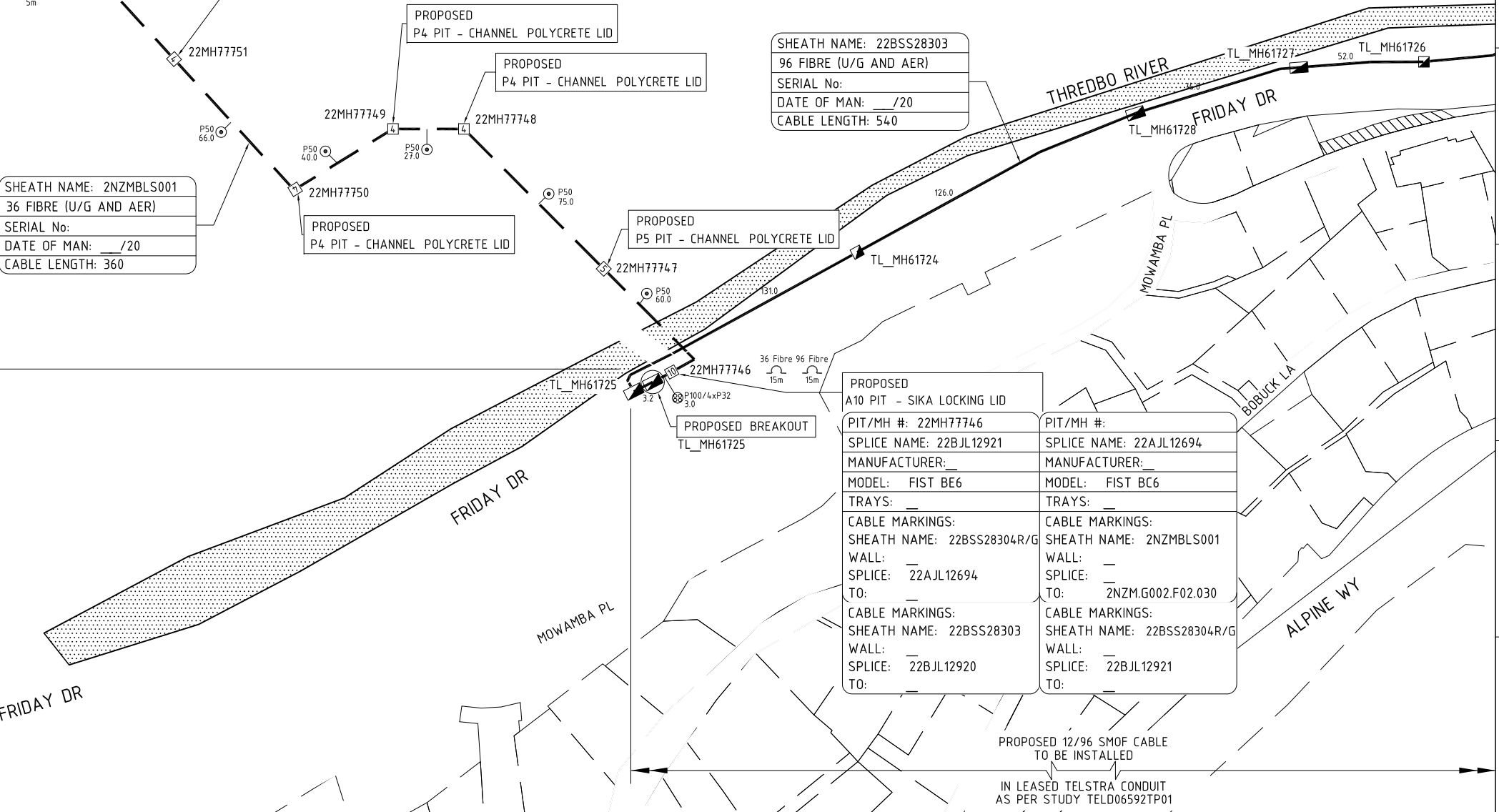
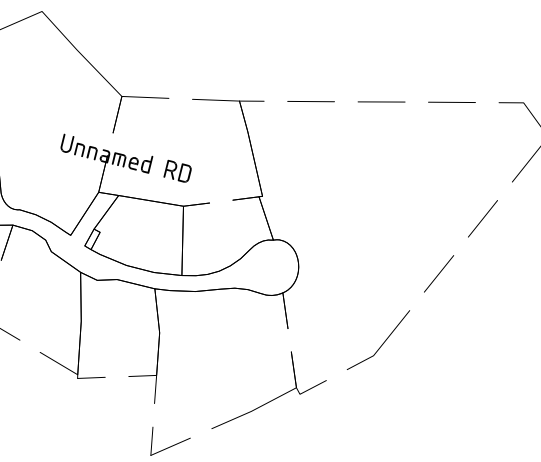

OPTUS DISCLAIMER
 THIS DOCUMENT HAS BEEN PREPARED SOLELY FOR THE USE OF OPTUS NETWORKS PTY. LTD. (ACN 008 570 330) FOR USE IN MAINTAINING OPTUS FACILITIES. IT HAS NOT BEEN CREATED FOR ANY OTHER USE. IT SHOULD NOT BE SCALED TO LOCATE OPTUS ASSET. NO WARRANTY IS GIVEN THAT THE INFORMATION IS ACCURATE OR COMPLETE. IF YOU REQUIRE FURTHER INFORMATION REGARDING THE LOCATION OF AN OPTUS ASSET PLEASE PHONE 1800 505 777.

LOCATION OF UTILITIES ARE INDICATIVE ONLY. ACTUAL LOCATIONS MUST BE DETERMINED ON SITE BY THE UTILITY OWNER FOR THE CONTRACTOR.

REV	DATE	DESCRIPTION	DRAWN	APPROVED
PD	20.01.16	PRELIMINARY DRAWING ISSUE	SNC	JV
AMENDMENTS				

SYMBOL LEGEND

---	CONDUIT - PROPOSED OPTUS CONSTRUCTION
---	CONDUIT - EXISTING
—A—	AERIAL STRAND (CATENARY WIRE)
DB	DIRECT BURIED CABLE
P50	CONDUIT CONFIGURATION PHOTO REFERENCE NUMBER REFER PHOTO PACK DOCUMENTATION

5	OPTUS 5 PIT	EM23	ENVIRONMENTAL NOTES REFER EWM SHEETS
8	OPTUS 8 PIT	○	FIBRE TERMINATION POINT
9	OPTUS 9 PIT	○	POWER POLE
10	OPTUS 10 PIT	▲	OPTUS MARKER POST
□	OTHER UTILITY PIT	721	FIBRE CABLE COIL
□	OTHER UTILITY MANHOLE	4.0m	FIBRE CABLE COIL LENGTH
□	OTHER UTILITY MANHOLE BREAKOUT REQUIRED	0.6	DEPTH OF COVER (m)
		2.4	CONDUIT OFFSET FROM PROPERTY LINE (m)

OPTUS *yes*

CONTRACTOR

CIS international
 Communications Infrastructure Services

KEY PLAN

001

002

003

YES OPTUS - FIBRE OPTIC CABLE PROJECTS

DRAWING TITLE:
 NSW (SYD) - FIBRE NETWORK
 THREDBO CBD GSM
 FRIDAY DR THREDBO
 FIBRE CABLE ROUTE

DUCT REFERENCE: TELD06592P01

PROJECT/EO No: --/E01866896

CADREF No: E01866896_PD.DWG

SCALE: 1:2000

SHEET No: 003

REV: PD

ENVIRONMENTAL WORK METHOD SUMMARY

- EM1** - SLOPING TERRAIN [5 DEGREES OR 9%]
 - MINIMAL DISTURBANCE TO EXISTING VEGETATION REINSTATE RIPLINE SURFACE, CONTOUR RIP, DIVERSION BANKS AT 50 METRES [REFER TO FIGURES 9.1(a), 9.2(b) & 9.4 OF SOIL CONSERVATION GUIDELINES], SEED AND FERTILISE, ONLY IF AGRICULTURAL LAND.
- EM2** - SLOPING TERRAIN [6 - 10 DEGREES OR 10 TO 18%]
 - MINIMAL DISTURBANCE TO EXISTING VEGETATION REINSTATE RIPLINE SURFACE, CONTOUR RIP, DIVERSION BANKS AT 30 METRES [REFER TO FIGURES 9.1(a), 9.1(b) & 9.4 OF SOIL CONSERVATION GUIDELINES], SEED AND FERTILISE, ONLY IF AGRICULTURAL LAND.
- EM3** - STEEP TERRAIN [11 - 17 DEGREES OR 19 TO 30%]
 - MINIMAL DISTURBANCE TO EXISTING VEGETATION, CONTOUR RIP, IF POSSIBLE BUT NOT IF UNSAFE. DIVERSION BANKS AT 16 METRES [REFER TO FIGURES 9.1(a), 9.2(b) & 9.4 OF SOIL CONSERVATION GUIDELINES. SEED AND FERTILISE IMMEDIATELY AFTER INSTALLATION. ONLY IF AGRICULTURAL.
- EM4** - VERY STEEP TERRAIN PROTECTED LANDS [SLOPE > 18% OR 30%]
 - NO TREES,SAPLINGS,SHRUBS OR SCRUB TO BE DISTURBED UNLESS NOTED ON THE DRAWINGS. EM3 TO RECTIFY THE SURFACE HOWEVER DIVERSION BANKS TO BE 10 METRES MAXIMUM INTERVAL.
- EM5** - GIANT PARRAMATTA GRASS INFESTED AREAS
 - 48 HOURS NOTICE TO LOCAL SHIRE COUNCIL PRIOR TO CONSTRUCTION COMMENCING ALL MACHINERY,EQUIPMENT & VEHICLES TO BE THOROUGHLY WASHED PRIOR TO LEAVING AN INFESTED AREA. WASH TO BE WITNESSED BY THE SHIRE COUNCIL REPRESENTATIVE IF SPECIFIED.
- EM6** - PRESCRIBED STREAMS, RIVERS & LAKES, IMPORTANT WATERWAYS OR WETLANDS
 - NO TREES,SAPLINGS,SHRUBS OR SCRUB TO BE CUT DOWN OR DESTROYED WITHIN 20 METRES OF THE BANK OR IN THE BED OF THE STREAM,RIVER OR LAKE UNLESS NOTED ON THE DRAWINGS. SLOPING AREAS TO BE TREATED IN ACCORDANCE WITH THE RELEVANT EM, EM1 TO EM4.
- EM7** - DISPERSIBLE SOILS [TUNNEL EROSION]
 - MINIMAL DISTURBANCE TO EXISTING VEGETATION,PRERIP IMMEDIATELY PRIOR TO SECONDARY RIPPING AND CABLE INSERTION. COMPACT TRENCH AS PRACTICAL. CONTOUR CULTIVATE AND DIVERSION BANKS AT INTERVALS DEPENDING ON SLOPE. SEED AND FERTILISE ONLY IF AGRICULTURAL LAND.
- EM8** - DISPERSIBLE SOILS - MAINTENANCE PROBLEM AREAS AND STEEP TERRAIN
 - IN ORDER TO LIMIT DISTURBANCE DURING WET CONDITION: MINIMISE VEHICLE DISTURBANCE DURING WET CONDITIONS DIVERT SUPPORT VEHICLES ALONG EXISTING TRACKS, IMPLEMENT OTHER SAFEGUARDS AS SPECIFIED (e.g. EM14 WORKS ON HOLD UNTIL DRY CONDITIONS, ETC.)

- EM9** - ACID SULPHATE SOILS
 - MINIMAL DISTURBANCE TO EXISTING VEGETATION,PRERIP IMMEDIATELY PRIOR TO SECONDARY RIPPING AND CABLE INSERTION.ADD 3:1 BACKFILL TO GYPSUM OR HYDRATED LIME (BY MASS) ON THE ACID SULPHATE CONTENT OF THE SOIL.CONSTRUCT DIVERSION BANKS AS REQUIRED DEPENDING ON SLOPE, SEED AND FERTILISE ONLY IF AGRICULTURAL LAND.
- EM10** - SALINE AREAS
 - APPLY EM6 AND REVEGETATE WITH SUITABLE SALT TOLERANT SPECIES AS ADVISED BY RELEVANT STATE AUTHORITY. REINSTATE SURFACE TO PRE-EXISTING CONDITION. IN SOME AREAS CURRENTLY BEING REHABILITATED DEEP RIPPING, SOIL MOUNDING (0.3 m HIGH, 1.0m SPACING) AND REPLANTING MAY BE SPECIFIED.
- EM11** - BRUSH MATTING
 - CUT UP ANY CLEARED MATERIAL OR CLEARED REGROWTH INTO 1m PIECES AND LAY NEATLY OVER DISTURBED AREAS AS BRUSH MATTING. ANY LARGE TIMBER SHOULD BE USED FOR EROSION CONTROL, OR VEHICLE ACCESS CONTROL. IF SPECIFIED, REMOVE LARGE TIMBER FROM SITE AND DISPOSE OF IN AN AUTHORISED AREA. N.B. ANY EXCESS MATERIAL IS NOT TO BE BURNT ON SITE OR ELSEWHERE UNLESS AUTHORISED.
- EM12** - ARID AND SEMI-ARID ZONE VEGETATION
 - SAMPHIRE VEGETATION, SALT BUSH AND BLUEBUSH COMMUNITIES - THIS SHRUBBY VEGETATION SHOULD NOT BE BLADED OUT DURING CONSTRUCTION. WHEREVER POSSIBLE, ALL EQUIPMENT SHOULD TRAVERSE AREAS WITHOUT THE BLADE IN CONTACT WITH THE GROUND, SO THAT THE VEGETATION IS ONLY CRUSHED, WITH ROOTS LEFT LARGELY INTACT, RATHER THAN BEING DESTROYED BY THE PASSES OF MACHINERY, SO THAT SOIL STABILITY AND SUCCESSFUL REGENERATION IS MAXIMISED. SEEDING WITH CONVENTIONAL GRASS OR PASTURE SPECIES MUST NOT BE UNDERTAKEN IN THESE AREAS UNLESS SPECIFIED ON THE DRAWINGS.
- EM13** - DIEBACK AREAS
 - FULL EQUIPMENT WASH-DOWN REQUIRED TO PREVENT SPREAD OF DIEBACK FUNGI (PHYTOPHERA) REFER TO DIEBACK HYGIENE PRESCRIPTION FOR THE PARTICULAR AREA
- EM14** - WETLAND AREAS
 - DIRECTIONAL BORE, NO DISTURBANCE TO VEGETATION ON MARGINS OR IN AREA SPECIFIED.
- EM15** - SANDHILLS / SAND DUNES
 - MINIMISE DISTURBANCE TO SOIL SURFACE AND VEGETATION, INCLUDING MINIMAL USE OF BLADES ON MACHINERY. DIVERT SUPPORT VEHICLES ALONG EXISTING TRACKS OUTSIDE THE DUNE AREA WHERE POSSIBLE OR SPECIFIED. RETAIN VEGETATION AS MUCH AS POSSIBLE, STABILISE DISTURBED AREAS WITH EITHER JUTE MESH, BRUSH MATTING, STRAW OR HYDROMULCH AS SPECIFIED, SEED AND FERTILISE IF SPECIFIED.
- EM16** - EXCESS ROCK REMOVAL
 - COLLECT AND DISPOSE OF EXCESS ROCK AT AUTHORIZED AREAS IN ORDER TO LEAVE THE SURFACE IN THE SAME CONDITION AS PREVIOUSLY.
- EM17** - WOMBAT HABITAT AREAS
 - DEVIATE BY UP TO 5m EITHER SIDE OF PEGGED ALIGNMENT TO AVOID DAMAGE TO WOMBAT BURROWS. TAKE CARE TO AVOID INJURY OR DEATH TO WOMBATS FROM MACHINERY OR VEHICLES.
- EM18** - WEED INFESTED AREAS
 - FULL EQUIPMENT WASH-DOWN AND OTHER REQUIREMENTS AS SPECIFIED TO PREVENT SPREAD OF WEEDS.

<p>OPTUS DISCLAIMER</p> <p>THIS DOCUMENT HAS BEEN PREPARED SOLELY FOR THE USE OF OPTUS NETWORKS PTY. LTD. (ACN 008 570 330) FOR USE IN MAINTAINING OPTUS FACILITIES. IT HAS NOT BEEN CREATED FOR ANY OTHER USE. IT SHOULD NOT BE SCALED TO LOCATE OPTUS ASSET. NO WARRANTY IS GIVEN THAT THE INFORMATION IS ACCURATE OR COMPLETE. IF YOU REQUIRE FURTHER INFORMATION REGARDING THE LOCATION OF AN OPTUS ASSET PLEASE PHONE 1800 505 777.</p>	<table border="1" style="width: 100%; border-collapse: collapse;"> <tr> <td>REV</td> <td>DATE</td> <td>DESCRIPTION</td> <td>DRAWN</td> <td>APPROVED</td> </tr> <tr> <td>PD</td> <td>20.01.16</td> <td>PRELIMINARY DRAWING ISSUE</td> <td>SNC</td> <td>JV</td> </tr> <tr> <td colspan="5" style="text-align: center;">AMENDMENTS</td> </tr> </table>	REV	DATE	DESCRIPTION	DRAWN	APPROVED	PD	20.01.16	PRELIMINARY DRAWING ISSUE	SNC	JV	AMENDMENTS					<p>SYMBOL LEGEND</p> <p>--- CONDUIT - PROPOSED OPTUS CONSTRUCTION</p> <p>— CONDUIT - EXISTING</p> <p>—A— AERIAL STRAND (CATENARY WIRE)</p> <p>DB DIRECT BURIED CABLE</p> <p>P50 CONDUIT CONFIGURATION</p> <p>PHOTO REFERENCE NUMBER REFER PHOTO PACK DOCUMENTATION</p>	<p>5 OPTUS 5 PIT</p> <p>8 OPTUS 8 PIT</p> <p>9 OPTUS 9 PIT</p> <p>10 OPTUS 10 PIT</p> <p>OTHER UTILITY PIT</p> <p>OTHER UTILITY MANHOLE</p> <p>OTHER UTILITY MANHOLE BREAKOUT REQUIRED</p>	<p>ENVIRONMENTAL NOTES REFER EWM SHEETS</p> <p>FIBRE TERMINATION POINT</p> <p>POWER POLE</p> <p>OPTUS MARKER POST</p> <p>FIBRE CABLE COIL</p> <p>FIBRE CABLE COIL LENGTH</p> <p>DEPTH OF COVER (m)</p> <p>CONDUIT OFFSET FROM PROPERTY LINE (m)</p>	<p>CONTRACTOR</p> <p> yes</p> <p> CIS international <small>Communications Infrastructure Services</small></p>	<p>KEY PLAN</p> <p>N</p>	<p>YES OPTUS - FIBRE OPTIC CABLE PROJECTS</p> <p>DRAWING TITLE: NSW (SYD) - FIBRE NETWORK THREDBO CBD GSM FRIDAY DR THREDBO FIBRE CABLE ROUTE</p> <p>DUCT REFERENCE: TEL06592TP01</p> <p>PROJECT/EO No: ---/E01866896</p> <p>CADREF No: E01866896_PD.DWG</p> <p>SCALE: 1:2000</p> <p>SHEET No: EWM1</p> <p>REV: PD</p>
REV	DATE	DESCRIPTION	DRAWN	APPROVED																		
PD	20.01.16	PRELIMINARY DRAWING ISSUE	SNC	JV																		
AMENDMENTS																						

ENVIRONMENTAL WORK METHOD SUMMARY

IMPORTANT FLORA/FAUNA

- EM19** - NO DISTURBANCE OFF THE APPROVED CABLE ALIGNMENT (INCLUDING SUPPORT VEHICLES, SPLICE PITS, STORAGE OF PLANT AND MACHINERY ETC.)
NOTE: ADDITIONAL ENVIRONMENTAL APPROVAL REQUIRED FOR ANY DEVIATIONS (EVEN WITHIN THE +5m NORMAL ALLOWANCE). IMPLEMENT OTHER SAFEGUARDS AS SPECIFIED.

EUROPEAN HERITAGE

- EM20** - HERITAGE ITEM/SITE NOT TO BE DISTURBED OR DAMAGED BY WORK ACTIVITIES. IMPLEMENT OTHER HERITAGE SAFEGUARDS AS SPECIFIED.

ABORIGINAL HERITAGE (SENSITIVE) AREA

- EM21** - NO DISTURBANCE OFF THE APPROVED CABLE ALIGNMENT (INCLUDING SUPPORT VEHICLES, SPLICE PITS, STORAGE OF PLANT AND MACHINERY ETC.)
NOTE: ADDITIONAL ENVIRONMENTAL APPROVAL REQUIRED FOR ANY DEVIATIONS (EVEN WITHIN THE +5m NORMAL ALLOWANCE). IMPLEMENT OTHER SAFEGUARDS AS SPECIFIED.

ABORIGINAL HERITAGE MONITORING AREA

- EM22** - APPLY EM21 AND ENSURE THAT THE SPECIFIED ABORIGINAL HERITAGE REPRESENTATIVE IS CONTACTED AT LEAST 7 DAYS PRIOR TO CONSTRUCTION TO ARRANGE FOR MONITORING.

STORMWATER DRAINAGE

- EM23** - MINIMISE SEDIMENT REACHING THE STORMWATER DRAIN. ERECT SEDIMENTATION FENCES AROUND ALL DISTURBED AREAS, STOCKPILES AND DRILLING MACHINES. SEDIMENTATION FENCE IS ALSO REQUIRED AROUND STORMWATER DRAINS WHILE WORKING WITHIN THE AREA. REMOVE SEDIMENTATION FENCES ONLY WHEN TRENCHING HAS BEEN COMPLETED, STOCKPILES OF SOIL REMOVED AND REHABILITATION COMPLETE.

STREETSCAPE

- EM24** - MINIMISE DAMAGE TO STREETSCAPE FEATURES e.g. KERBING OR DRAINS, NATURE STRIP GARDEN, FOOTPATHS, DRIVEWAYS ETC. REINSTATE TO ORIGINAL CONDITION.

URBAN DRIVEWAY

- EM25** - BORE UNDER DRIVEWAY.

TURF

- EM26** - TURF IS TO BE CUT INTO NEAT SQUARES, STOCKPILED AND RE-USED.

HERITAGE STREETSCAPE

- EM27** - NO TREE SAPLINGS, SHRUBS OR STREETSCAPE ELEMENTS e.g. STREET FURNITURE ARE TO BE DISTURBED UNLESS NOTED ON THE DRAWINGS. CONFIRM COUNCIL AGREEMENT PRIOR TO WORK COMMENCING.

HERITAGE KERB AND GUTTERING

- EM28** - EXTREME CARE KERB AND GUTTERING IS NOT DAMAGED IN ANY WAY. IF DAMAGED, THESE ITEMS CANNOT BE REPLACED.

HERITAGE TREE

- EM29** - TREE NOT TO BE DISTURBED. DO NOT DAMAGE TREE IN ANY WAY. PROTECT TRUNK OR BRANCHES WITH HESSIAN, BARRICADES OR BOARDS, WHICH MUST BE REMOVED UPON COMPLETION OF WORK.

HERITAGE ITEM

- EM30** - HERITAGE ITEM NOT TO BE DISTURBED OR DAMAGED. GAIN APPROVAL IF THE ACTIVITIES ARE LIKELY TO HAVE SIGNIFICANT IMPACT.

HERITAGE BUILDING

- EM31** - CARE IS TO BE TAKEN TO AVOID DAMAGE TO HERITAGE LISTED BUILDINGS AND THEIR FACADES/FENCES OR OTHER IMPORTANT FEATURES. BARRICADES AND/OR EXCLUSION FENCING MUST BE USED TO PREVENT MACHINERY MOVEMENT IMPACTING ON HERITAGE LISTED BUILDINGS AND THEIR FACADES.

HERITAGE FENCES

- EM32** - EQUIPMENT AND MATERIAL STOCKPILES MUST NOT BE PLACED AGAINST OR ADJACENT TO HERITAGE BUILDINGS AND THEIR FACADES/FENCES OR OTHER IMPORTANT FEATURES.

URBAN ABORIGINAL HERITAGE SITES

- EM33** - NO WORKS PERMITTED WITHIN PROPERTY BOUNDARY OF HERITAGE ITEM/SITE.

ARCHAEOLOGICAL SITE

- EM34** - AREA OF HIGH SENSITIVITY. ARCHAEOLOGICAL MONITORING IS REQUIRED DURING CONSTRUCTION. AT LEAST 7 DAYS NOTICE REQUIRED PRIOR TO CONSTRUCTION BEGINNING IN ORDER TO ARRANGE FOR MONITORING.

TREES

- EM35** - MINIMAL DISTURBANCE TO THE CANOPY AND TRUNKS OF TREES WHEN WORKING WITH MACHINERY IN CLOSE PROXIMITY. IF TREE TRUNKS ARE LIKELY TO BE DAMAGED BY PIVOT AND SWIVEL OF MACHINERY, THEY SHOULD BE TEMPORARILY PROTECTED WITH SUITABLE MATERIALS (e.g. SEVERAL LAYERS OF HESSIAN WRAPPING, PALING SECURED WITH WIRE etc. WHICH MUST BE REMOVED WHEN WORK IS COMPLETE). IF OVERHANGING TREE BRANCHES ARE WITHIN THE WORKING AREA THE OPTUS TREE TRIMMING POLICY SHALL APPLY. IF UNDERGROUNDING IS TO BE WITHIN DRIP LINE OF TREE, CARE IS TO TAKEN. USE HAND TRENCHING OR BORING METHODS. DAMAGE TO THE TREE AND ITS ROOT SYSTEM SHOULD BE KEPT TO A MINIMUM.

PAVED FOOTPATHS/PAVING

- EM36** - BORING IS PREFERRED. IF TRENCHING IS REQUIRED, PAVERS ARE TO BE LIFTED OUT OF POSITION BEFORE TRENCHING AND STACKED NEATLY TO ONE SIDE. AFTER BACKFILLING OF TRENCH IS COMPLETE, PAVERS ARE TO BE RELAID ACCORDING TO INDUSTRY STANDARDS.

<p>OPTUS DISCLAIMER</p> <p>THIS DOCUMENT HAS BEEN PREPARED SOLELY FOR THE USE OF OPTUS NETWORKS PTY. LTD. (ACN 008 570 330) FOR USE IN MAINTAINING OPTUS FACILITIES. IT HAS NOT BEEN CREATED FOR ANY OTHER USE. IT SHOULD NOT BE SCALED TO LOCATE OPTUS ASSET. NO WARRANTY IS GIVEN THAT THE INFORMATION IS ACCURATE OR COMPLETE. IF YOU REQUIRE FURTHER INFORMATION REGARDING THE LOCATION OF AN OPTUS ASSET PLEASE PHONE 1800 505 777.</p>	<table border="1" style="width: 100%; border-collapse: collapse;"> <tr> <td>REV</td> <td>DATE</td> <td>DESCRIPTION</td> <td>DRAWN</td> <td>APPROVED</td> </tr> <tr> <td>PD</td> <td>20.01.16</td> <td>PRELIMINARY DRAWING ISSUE</td> <td>SNC</td> <td>JV</td> </tr> <tr> <td colspan="5" style="text-align: center;">AMENDMENTS</td> </tr> </table>	REV	DATE	DESCRIPTION	DRAWN	APPROVED	PD	20.01.16	PRELIMINARY DRAWING ISSUE	SNC	JV	AMENDMENTS					<p>SYMBOL LEGEND</p> <p>--- CONDUIT - PROPOSED OPTUS CONSTRUCTION</p> <p>— CONDUIT - EXISTING</p> <p>—A— AERIAL STRAND (CATENARY WIRE)</p> <p>DB DIRECT BURIED CABLE</p> <p>P50 CONDUIT CONFIGURATION</p> <p>PHOTO REFERENCE NUMBER</p> <p>REFER PHOTO PACK DOCUMENTATION</p>	<p>5 OPTUS 5 PIT</p> <p>8 OPTUS 8 PIT</p> <p>9 OPTUS 9 PIT</p> <p>10 OPTUS 10 PIT</p> <p>OTHER UTILITY PIT</p> <p>OTHER UTILITY MANHOLE</p> <p>OTHER UTILITY MANHOLE BREAKOUT REQUIRED</p>	<p>ENVIRONMENTAL NOTES</p> <p>REFER EWM SHEETS</p> <p>FIBRE TERMINATION POINT</p> <p>POWER POLE</p> <p>OPTUS MARKER POST</p> <p>FIBRE CABLE COIL</p> <p>FIBRE CABLE COIL LENGTH</p> <p>DEPTH OF COVER (m)</p> <p>CONDUIT OFFSET FROM PROPERTY LINE (m)</p>	<p>OPTUS <i>yes</i></p> <p>CONTRACTOR</p> <p>CIS international</p> <p>Communications Infrastructure Services</p>	<p>N KEY PLAN</p>	<p>YES OPTUS - FIBRE OPTIC CABLE PROJECTS</p> <p>DRAWING TITLE:</p> <p>NSW (SYD) - FIBRE NETWORK</p> <p>THREDBO CBD GSM</p> <p>FRIDAY DR THREDBO</p> <p>FIBRE CABLE ROUTE</p> <p>DUCT REFERENCE: TELD06592TP01</p> <p>PROJECT/EO No: --/E01866896</p> <p>CADREF No: E01866896_PD.DWG</p> <p>SCALE 1:2000</p> <p>SHEET No: EWM2</p> <p>REV PD</p>
REV	DATE	DESCRIPTION	DRAWN	APPROVED																		
PD	20.01.16	PRELIMINARY DRAWING ISSUE	SNC	JV																		
AMENDMENTS																						